

- KEY:**
- 1 22,500 litre fire supply tank
 - 2 22,500 litre fire supply tank
 - 3 67,500 litre tank-Linked at base-Overflow to Tank 7
 - 4 67,500 litre tank-Linked at base-Overflow to Tank 7
 - 5 67,500 litre tank-Linked at base-Overflow to Tank 7
 - 6 67,500 litre tank-Linked at base-Overflow to Tank 7
 - 7 67,500 litre tank-Linked at base-Overflow to Tank 7
 - 8 30,000 litre tank for irrigation
 - 9 30,000 litre tank for irrigation
 - 10 30,000 litre tank for irrigation
 - 11 9,000 litre Silt Trap
 - 12 30,000 litre tank detention tank
 - 13 30,000 litre water supply tank for A3

Piped Services Trench Type:
Refer trench sections for detail- SHEET S-105

- Trench A
- Trench B
- Trench C
- Trench D
- Trench E
- Trench F
- Trench G
- Trench H

- SW Roofwater: 150mm diameter SW supply from roof to RW tanks
- SS Waste water: 100mm diameter WW drain @ 1:80 fall to septic effluent tank
- W Water supply: 63mm diameter potable pressure pipe to supply buildings
- CP Surface water + Ground Water: 225mm diameter (unless otherwise specified) surface area runoff

Refer Deane Consultants Stormwater Report for location of sample bore-holes.

1 OVERALL SITE SERVICES PLAN
1:500

09.09.21-REVISED ISSUE	
SITE ADDRESS:	20 OMAHA BLOCK ACCESS ROAD LEIGH
LEGAL DESCRIPTION:	OMAHA 3 BLOCK- ML 148515
SITE AREA:	9.0421 HECTARES MORE OR LESS
DATE: 9/09/21	

S-01

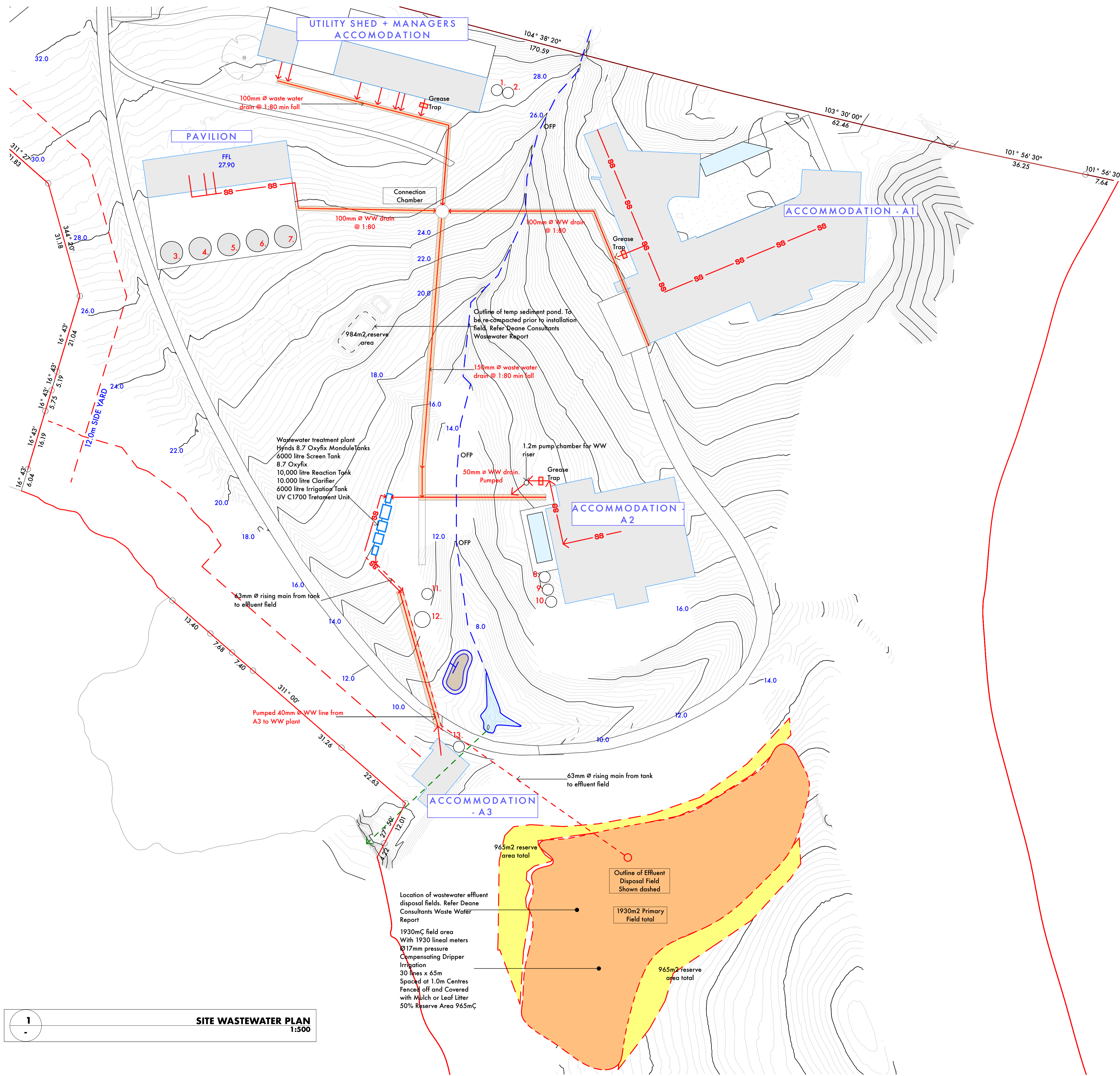

- KEY:**
- 1 22,500 litre fire supply tank
 - 2 22,500 litre fire supply tank
 - 3 67,500 litre tank-Linked at base-Overflow to Tank 7
 - 4 67,500 litre tank-Linked at base-Overflow to Tank 7
 - 5 67,500 litre tank-Linked at base-Overflow to Tank 7
 - 6 67,500 litre tank-Linked at base-Overflow to Tank 7
 - 7 67,500 litre tank-Linked at base-Overflow to Tank 7
 - 8 30,000 litre tank for irrigation
 - 9 30,000 litre tank for irrigation
 - 10 30,000 litre tank for irrigation
 - 11 9,000 litre Silt Trap
 - 12 30,000 litre tank detention tank
 - 13 30,000 litre water supply tank for A3

- Piped Services Trench:
Refer Sheet S-05 Trench Sections
for type
- SS → Waste Water drains:
WW drains @ min 1:80 fall to connect
into main WW drain in services trench.
- Waste water:
100mm diameter WW drain @ 1:80 fall to
septic effluent tank. Refer Deane
Wastewater report

1
SITE WASTEWATER PLAN
1:500

Location of wastewater effluent disposal fields. Refer Deane Consultants Waste Water Report

1930m² field area
With 1930 lineal meters
Ø17mm pressure
Compensating Dripper
Irrigation
30 lines x 65m
Spaced at 1.0m Centres
Fenced off and Covered
with Mulch or Leaf Litter
50% Reserve Area 965m²

09.09.21-REVISED ISSUE	
SITE ADDRESS:	20 OMAHA BLOCK ACCESS ROAD LEIGH
LEGAL DESCRIPTION:	OMAHA 3 BLOCK- ML 148515
SITE AREA:	9.0421 HECTARES MORE OR LESS
DATE: 9/09/21	

S-02

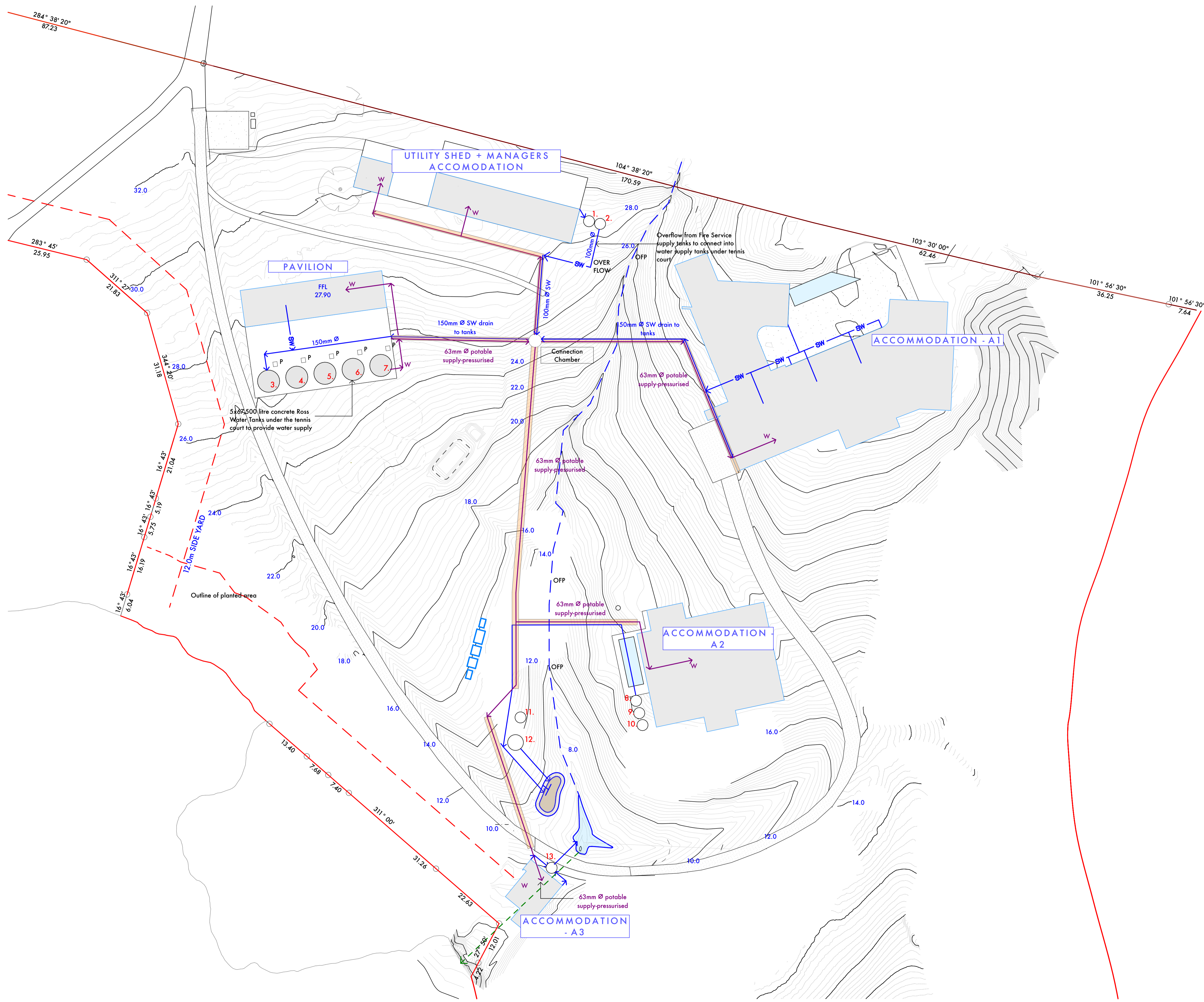

- KEY:**
- 1 22,500 litre fire supply tank
 - 2 22,500 litre fire supply tank
 - 3 67,500 litre tank-Linked at base-Overflow to Tank 7
 - 4 67,500 litre tank-Linked at base-Overflow to Tank 7
 - 5 67,500 litre tank-Linked at base-Overflow to Tank 7
 - 6 67,500 litre tank-Linked at base-Overflow to Tank 7
 - 7 67,500 litre tank-Linked at base-Overflow to Tank 7
 - 8 30,000 litre tank for irrigation
 - 9 30,000 litre tank for irrigation
 - 10 30,000 litre tank for irrigation
 - 11 9,000 litre Silt Trap
 - 12 30,000 litre tank detention tank
 - 13 30,000 litre water supply tank for A3

- Piped Services Trench:
Refer Sheet S-05 Trench Sections
for type
- SW → Roofwater: 100mm diameter SW drains @
1:80 to connect into main SW line
connecting to rain tanks
- Roofwater: 150mm diameter SW
supply from roof to RW tanks
under tennis court
- W → Water supply: 63mm diameter potable pressure
pipe to supply buildings

09.09.21-REVISED ISSUE	
SITE ADDRESS:	20 OMAHA BLOCK ACCESS ROAD LEIGH
LEGAL DESCRIPTION:	OMAHA 3 BLOCK- ML 148515
SITE AREA:	9.0421 HECTARES MORE OR LESS
DATE: 9/09/21	

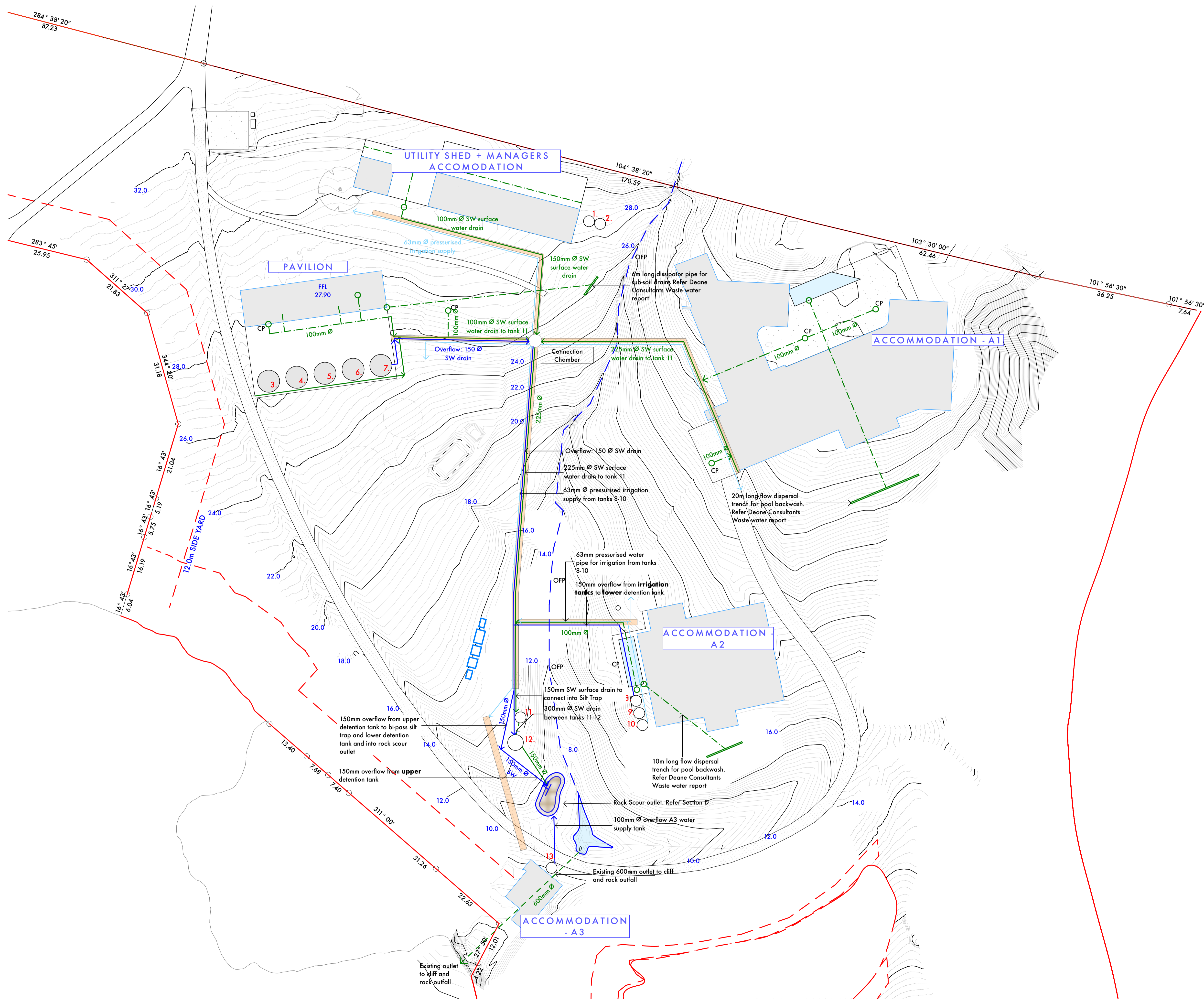

- KEY:**
- 1 22,500 litre fire supply tank
 - 2 22,500 litre fire supply tank
 - 3 67,500 litre tank-Linked at base-Overflow to Tank 7
 - 4 67,500 litre tank-Linked at base-Overflow to Tank 7
 - 5 67,500 litre tank-Linked at base-Overflow to Tank 7
 - 6 67,500 litre tank-Linked at base-Overflow to Tank 7
 - 7 67,500 litre tank-Linked at base-Overflow to Tank 7
 - 8 30,000 litre tank for irrigation
 - 9 30,000 litre tank for irrigation
 - 10 30,000 litre tank for irrigation
 - 11 9,000 litre Silt Trap
 - 12 30,000 litre tank detention tank
 - 13 30,000 litre water supply tank for A3

- Piped Services Trench:
Refer Sheet S-05 Trench Sections for type
- SW drain from paved area cess pits to connect into main SW drain in services trench. Refer plan for diameter drain
- Surface water + Ground Water Drain:
225mm diameter. To silt trap and lower detention tank (tanks 11+12)
- Overflow drains:
150mm diameter overflow drain
150mm drain from upper detention tank to connect into existing rock scour
150mm drain from irrigation tanks to connect into existing rock scour via lower detention tank
- 63mm diameter pressurised irrigation supply pipe

09.09.21-REVISED ISSUE

SITE ADDRESS:	20 OMAHA BLOCK ACCESS ROAD LEIGH
LEGAL DESCRIPTION:	OMAHA 3 BLOCK- ML 148515
SITE AREA:	9.0421 HECTARES MORE OR LESS

DATE: 9/09/21

1 SITE SURFACE WATER, OVERFLOWS + IRRIGATION SUPPLY PLAN
1:500

S-04

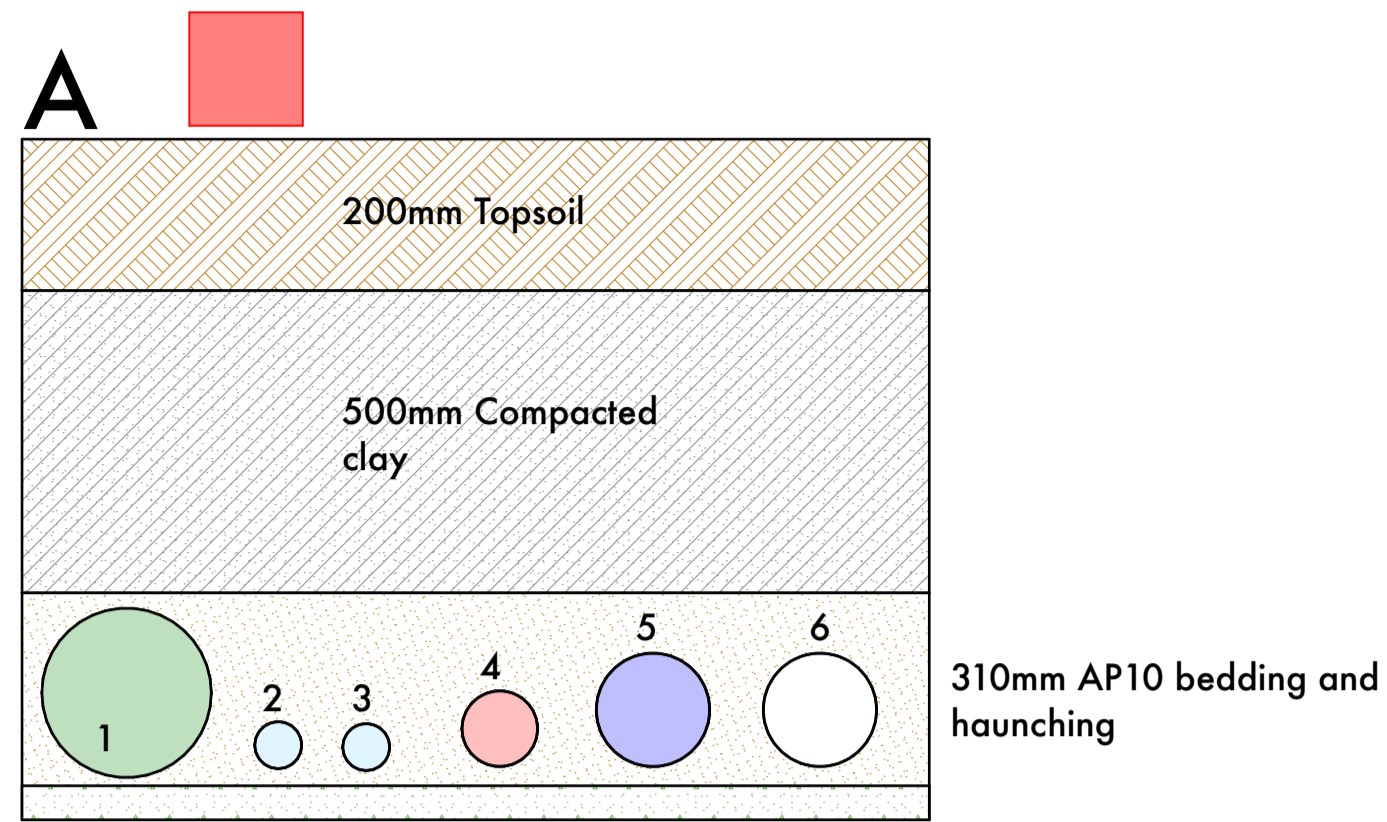

SERVICES TRENCH A

1. 225mm Ø paved area runoff drain
2. 63mm Ø potable pressurised water supply pipe
3. 63mm Ø irrigation pressurised water supply pipe
4. 100mm Ø waste water drain @ min 1:80 fall
5. 150mm Ø water supply tanks overflow
6. 150mm Ø spare duct for services

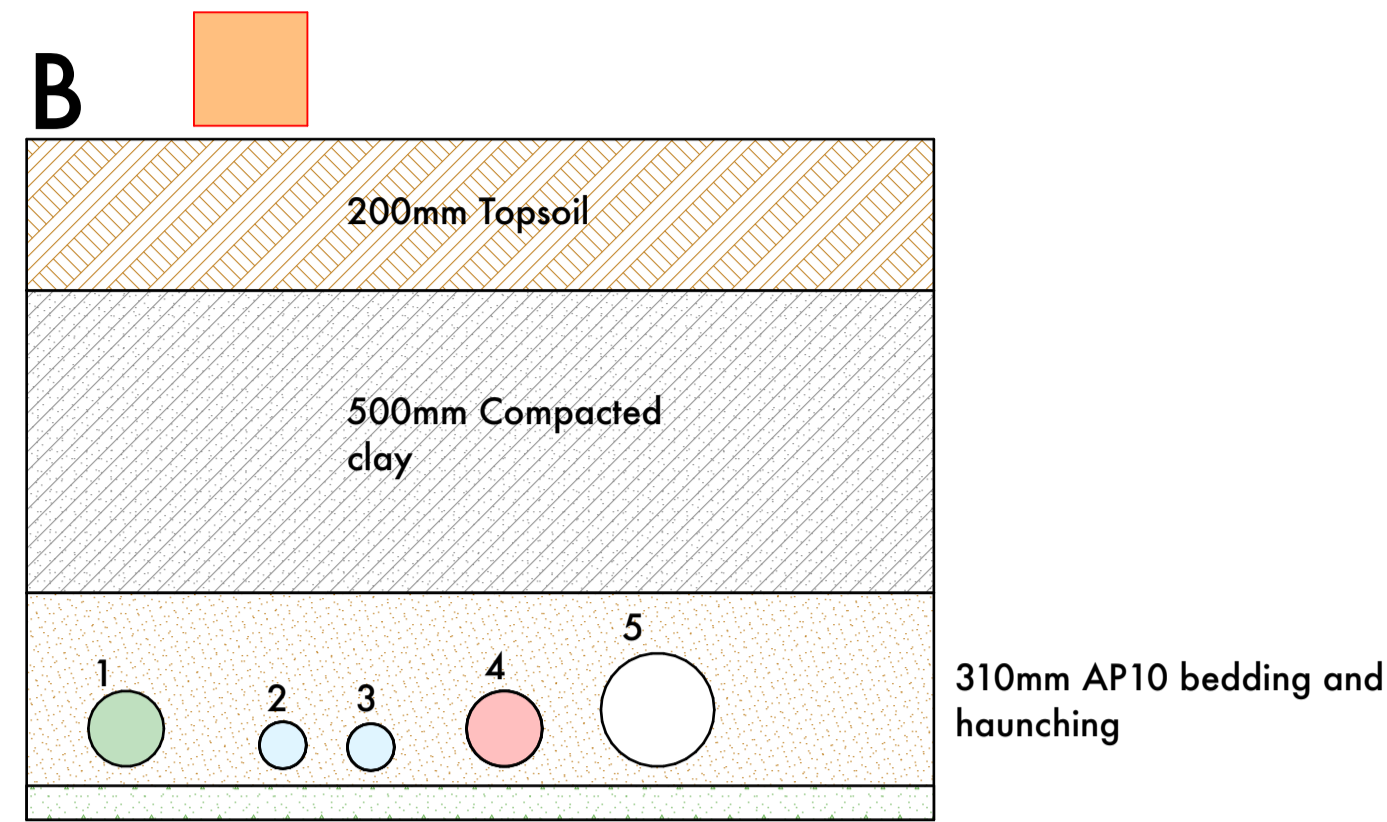

SERVICES TRENCH B

1. 100mm Ø paved area runoff drain
2. 63mm Ø potable pressurised water supply pipe
3. 63mm Ø irrigation pressurised water supply pipe
4. 100mm Ø waste water drain @ min 1:80 fall
5. 150mm Ø spare duct for services

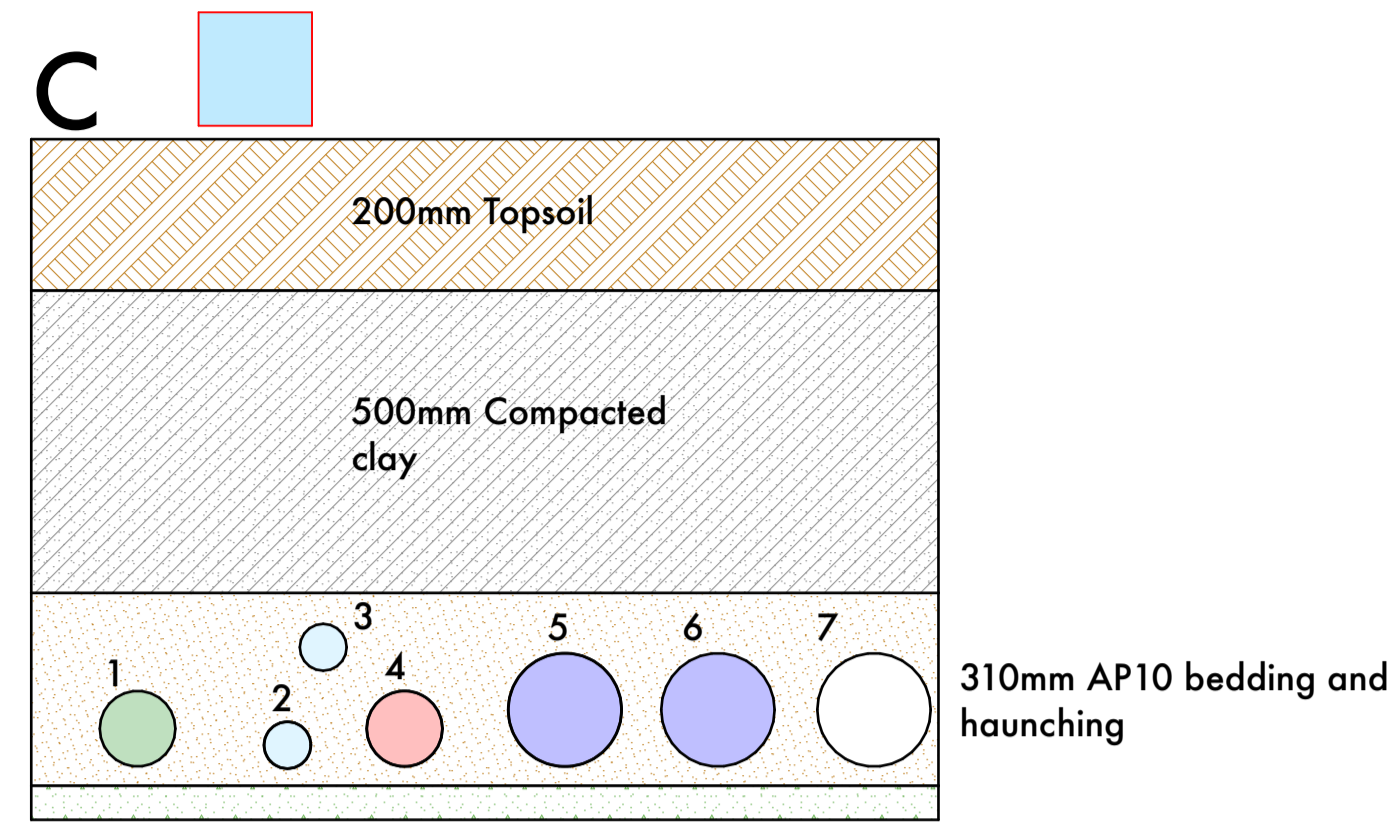

SERVICES TRENCH C

1. 100mm Ø paved area runoff drain
2. 63mm Ø potable pressurised water supply pipe
3. 63mm Ø irrigation pressurised water supply pipe
4. 100mm Ø waste water drain @ min 1:80 fall
5. 150mm Ø **overflow from water supply tanks**
6. 150mm Ø SW drain from roof to water supply tanks
7. 150mm Ø spare duct for services

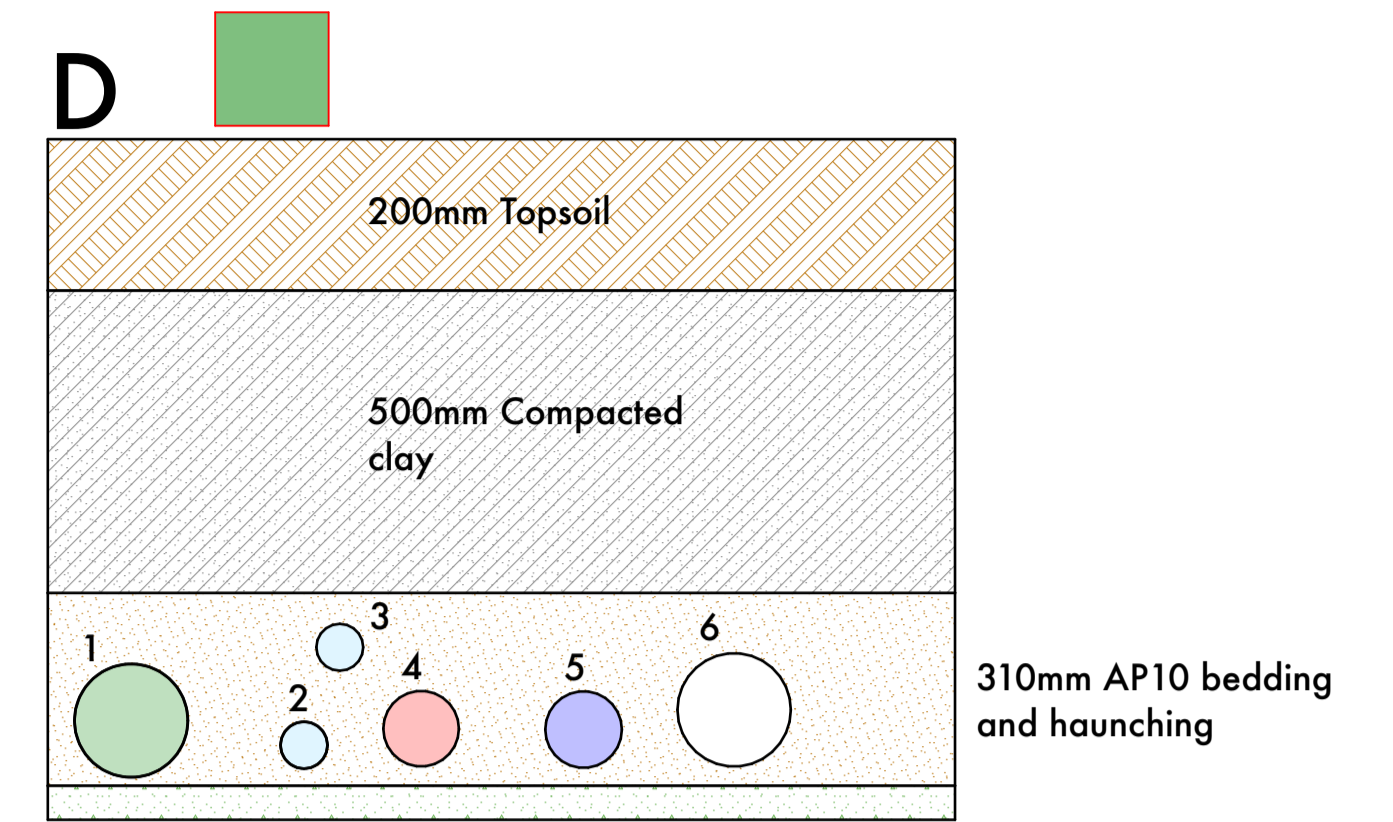

SERVICES TRENCH D

1. 150mm Ø paved area runoff drain
2. 63mm Ø potable pressurised water supply pipe
3. 63mm Ø irrigation pressurised water supply pipe
4. 100mm Ø waste water drain @ min 1:80 fall
5. 100mm Ø **overflow from fire supply tanks** to water supply tanks
6. 150mm Ø spare duct for services

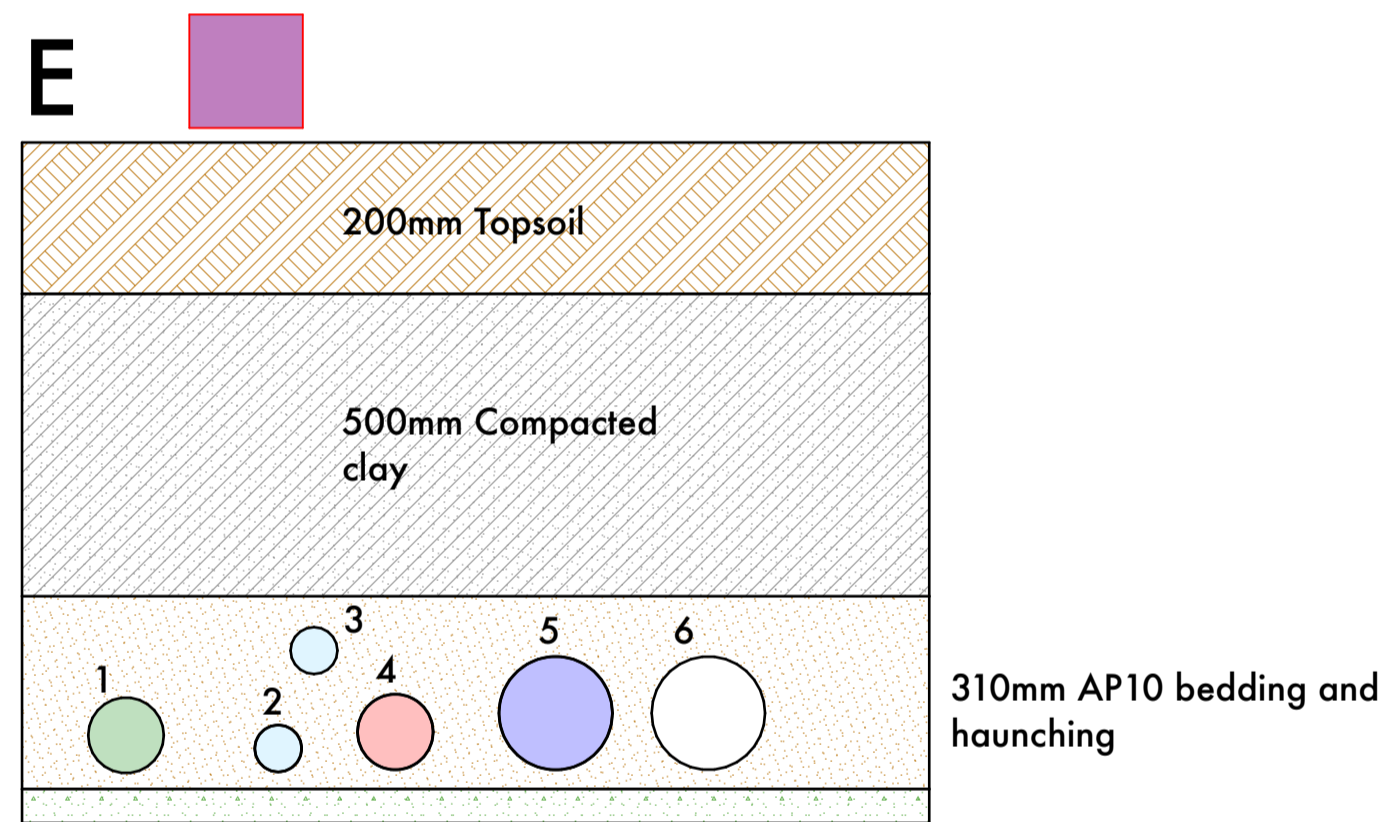

SERVICES TRENCH E

1. 100mm Ø paved area runoff drain
2. 63mm Ø potable pressurised water supply pipe
3. 63mm Ø irrigation pressurised water supply pipe
4. 100mm Ø waste water drain @ min 1:80 fall
5. 150mm Ø drain **overflow from irrigation tank**
6. 150mm Ø spare duct for services

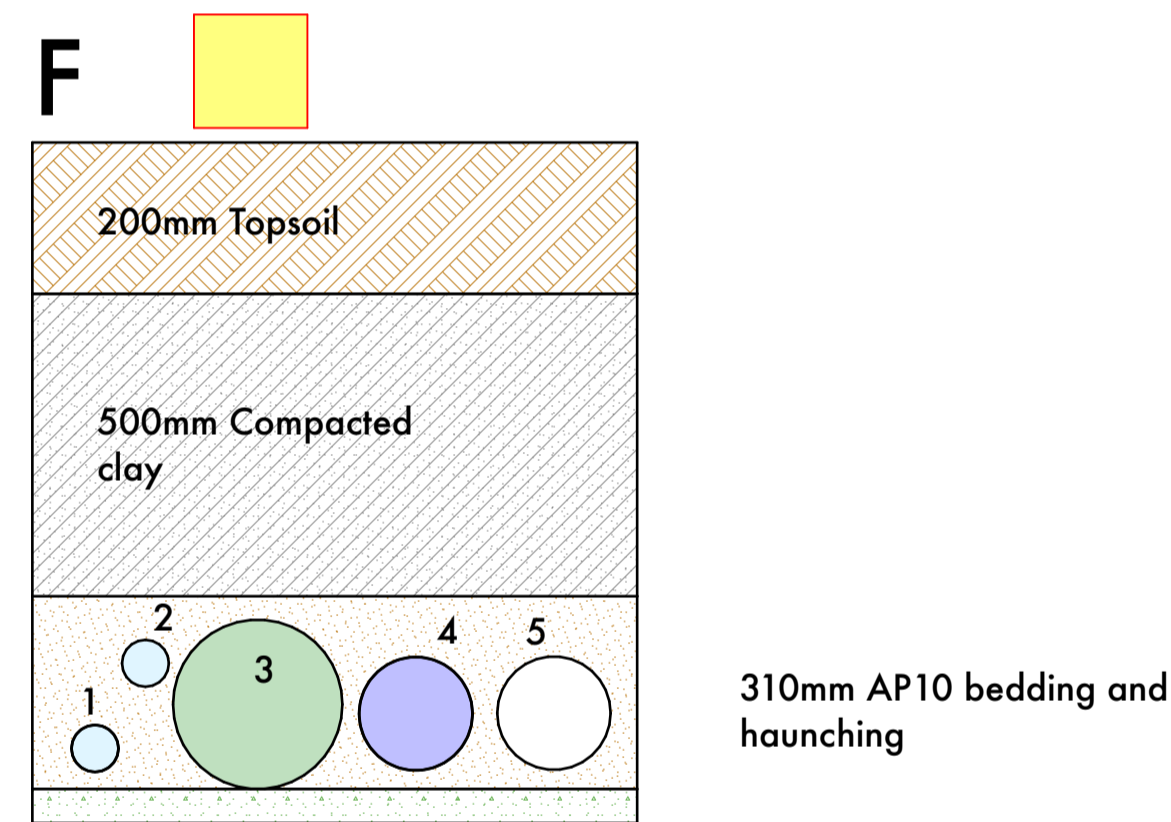

SERVICES TRENCH F

1. 63mm Ø potable pressurised water supply pipe
2. 63mm Ø irrigation pressurised water supply pipe
3. 225mm Ø paved area runoff drain
4. 150mm Ø water supply tanks overflow
5. 150mm Ø spare duct for services

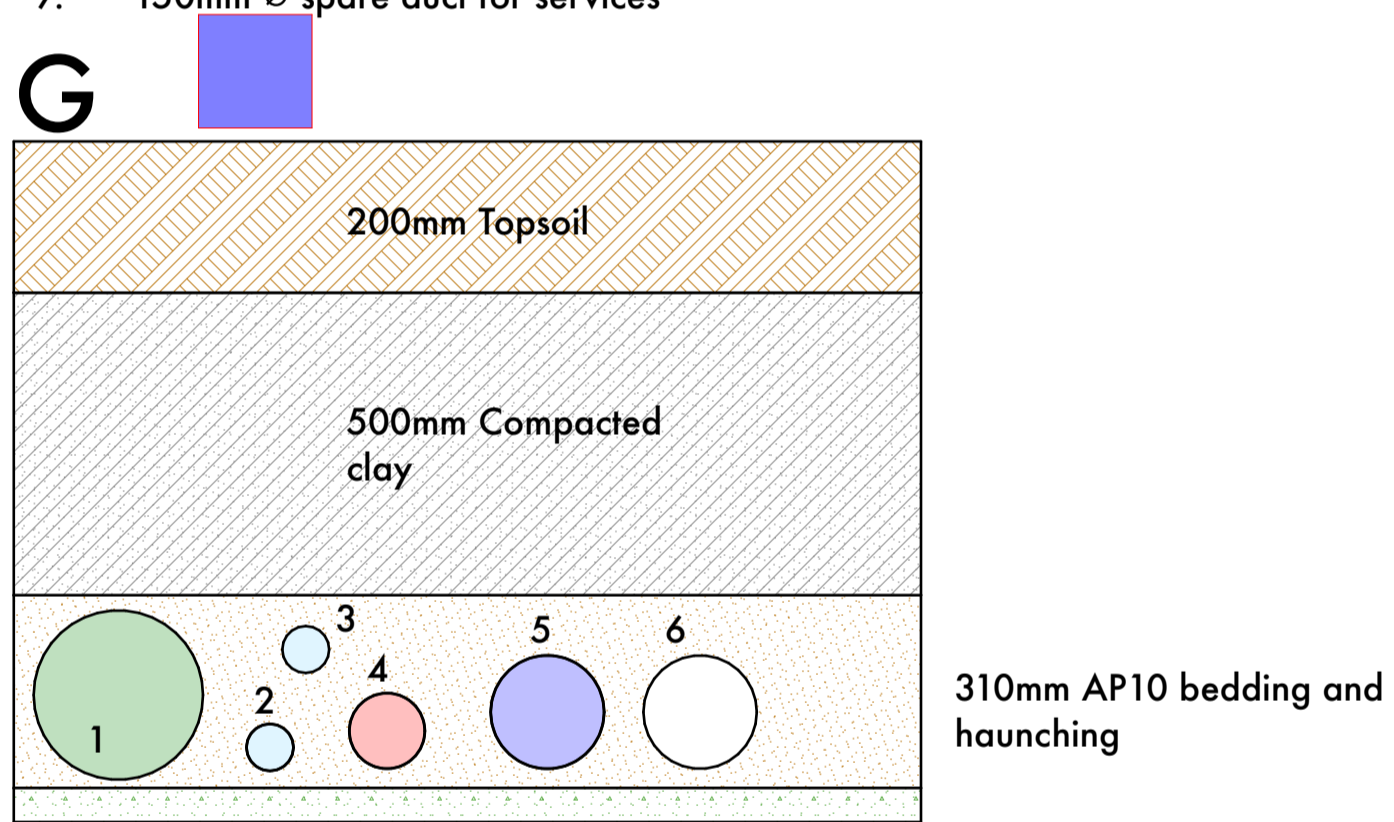

SERVICES TRENCH D

1. 225mm Ø paved area runoff drain
2. 63mm Ø potable pressurised water supply pipe
3. 63mm Ø irrigation pressurised water supply pipe
4. 100mm Ø waste water drain @ min 1:80 fall
5. 150mm Ø SW drain from roof to water supply tanks
6. 150mm Ø spare duct for services

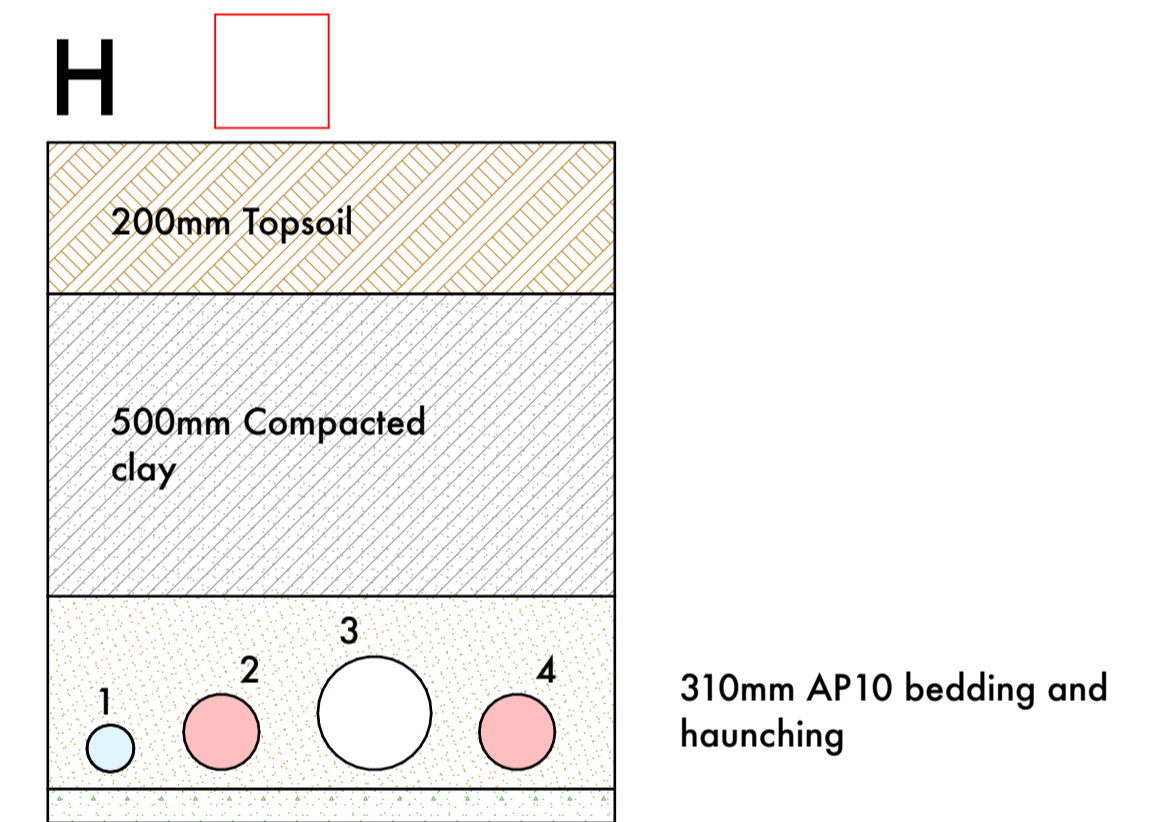

SERVICES TRENCH H

1. 63mm Ø irrigation pressurised water supply pipe
2. 40mm Ø waste water drain. Pumped
3. 150mm Ø spare duct for services
4. 63mm Ø rising main from WW treatment plant to effluent disposal field. Pumped

09.09.21-REVISED ISSUE

SITE ADDRESS:	20 OMAHA BLOCK ACCESS ROAD LEIGH
LEGAL DESCRIPTION:	OMAHA 3 BLOCK- ML 148515
SITE AREA:	9.0421 HECTARES MORE OR LESS

DATE: 9/09/21

S-05

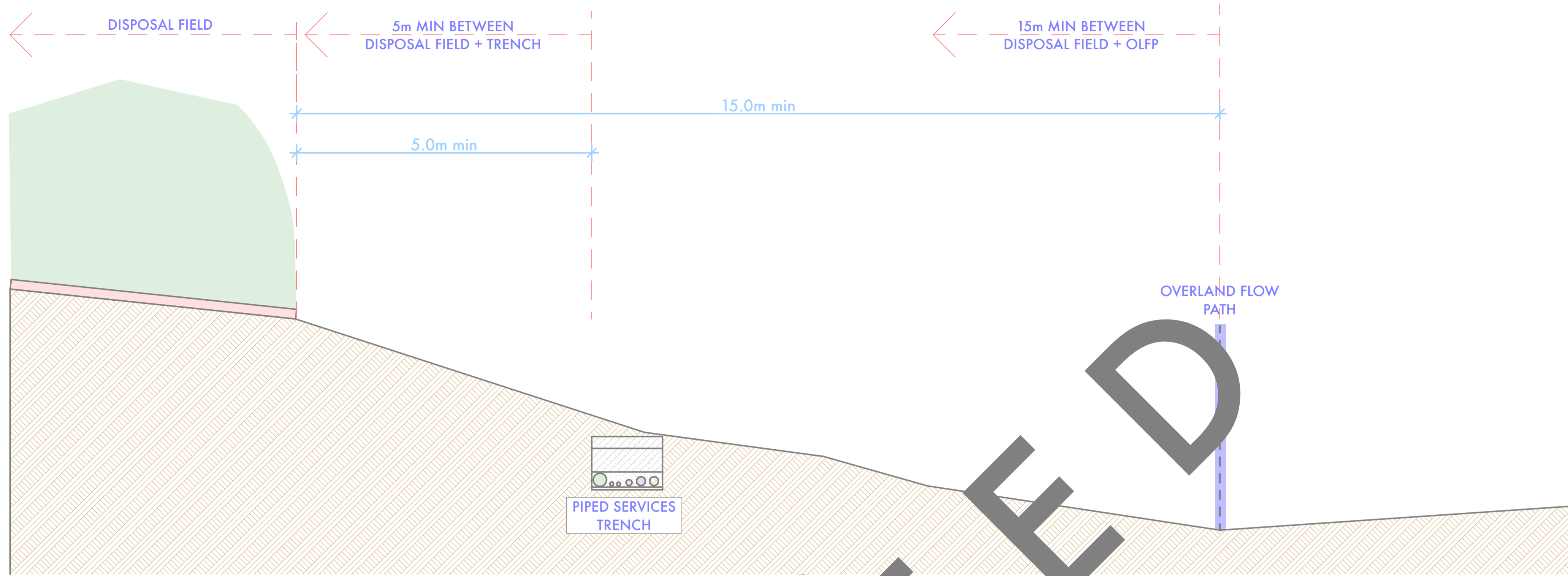

1 SECTION A-OLFP 1:50

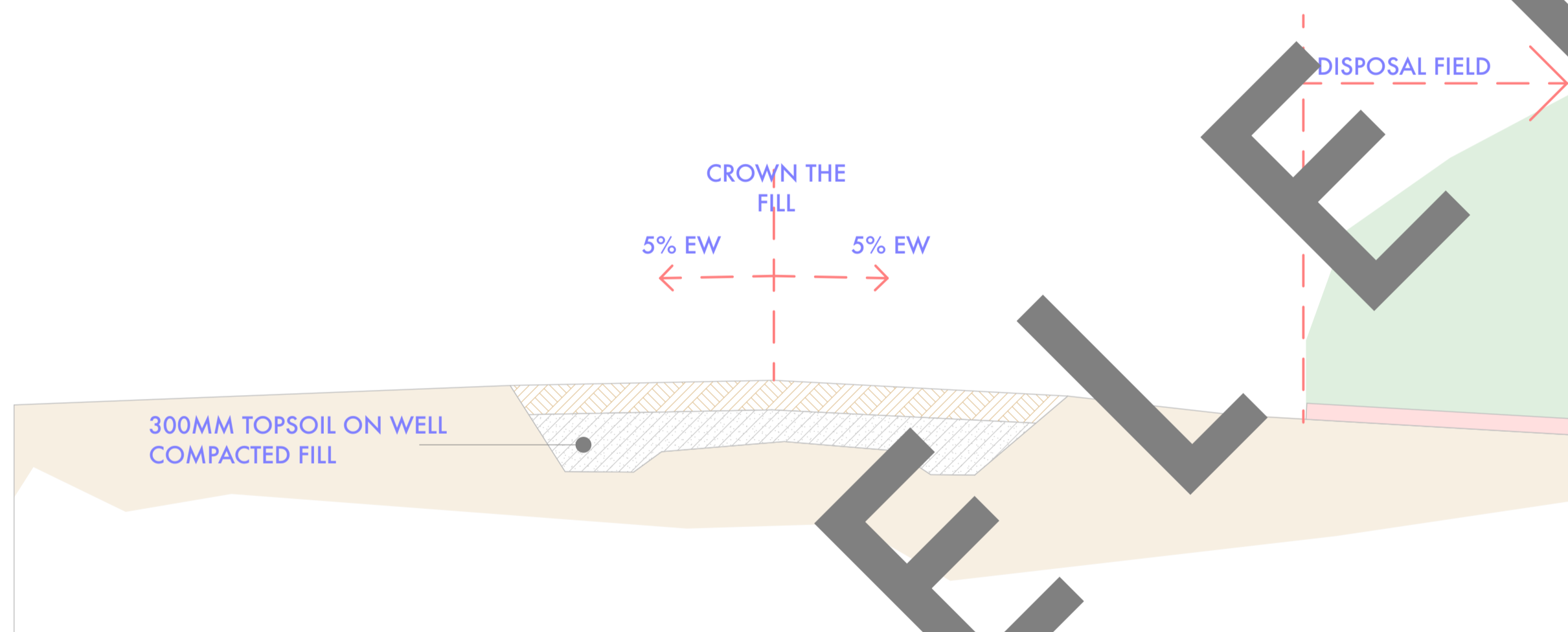

2 SECTION B-DRIVEWAY 1:50

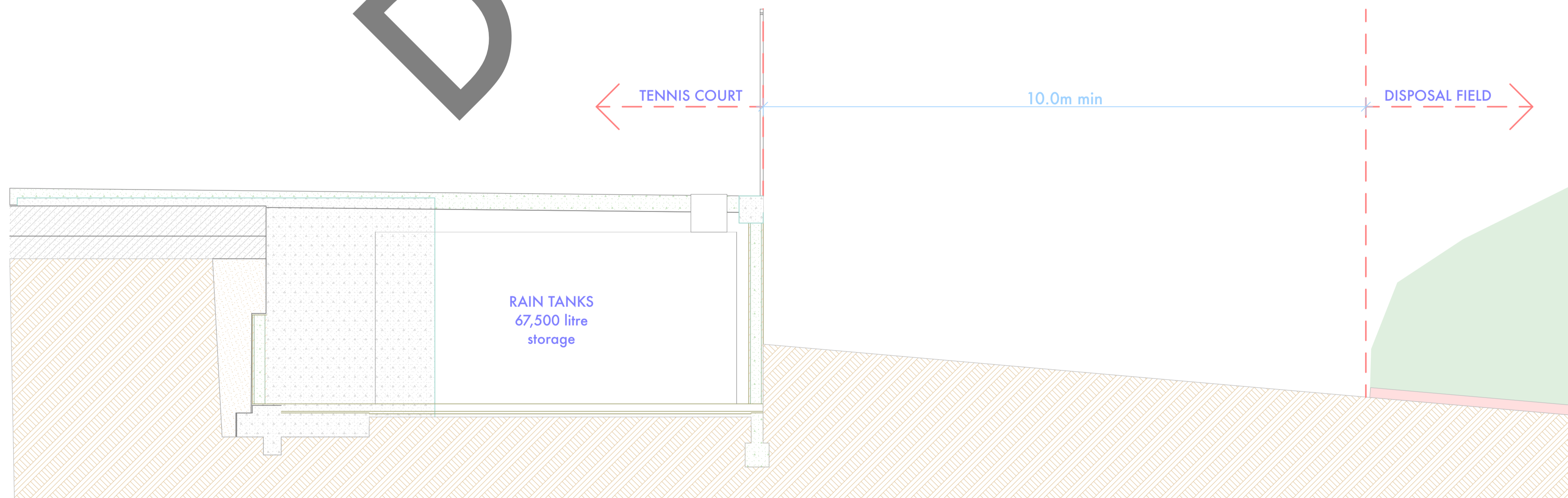

3 SECTION C-RAIN TANKS 1:50

09.09.21-REVISED ISSUE	
SITE ADDRESS:	20 OMAHA BLOCK ACCESS ROAD LEIGH
LEGAL DESCRIPTION:	OMAHA 3 BLOCK- ML 148515
SITE AREA:	9.0421 HECTARES MORE OR LESS
DATE: 9/09/21	

S-06

Formed rock scour with 150mm outlet pipe to allow trickle supply into existing OLFP and outlet under road

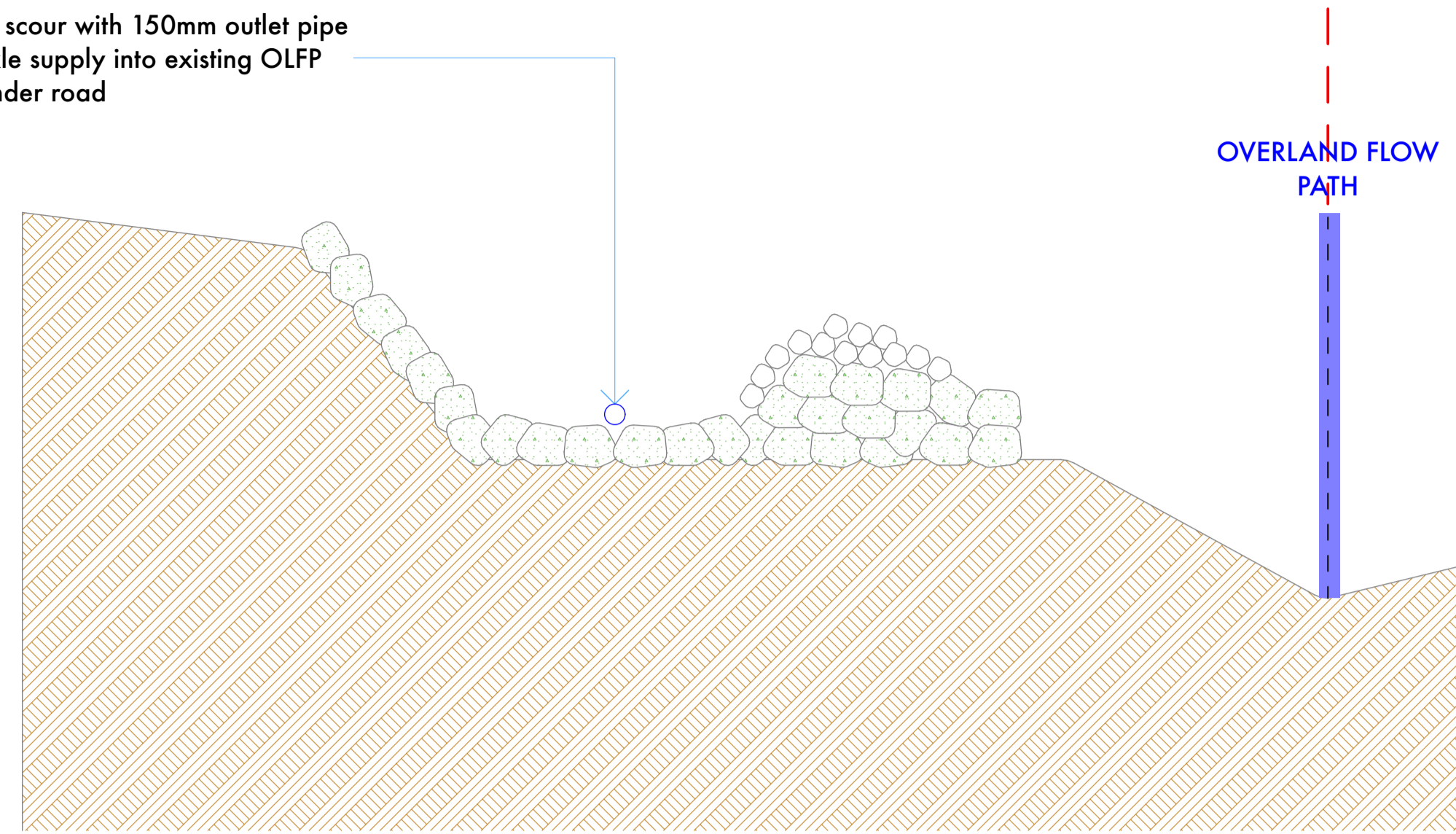

1
SECTION D-ROCK SCOUR OUTLET
1:50

Stainless steel perforated conduit tray supported by 380 PFC pipe bridge. Refer Sectional Detail

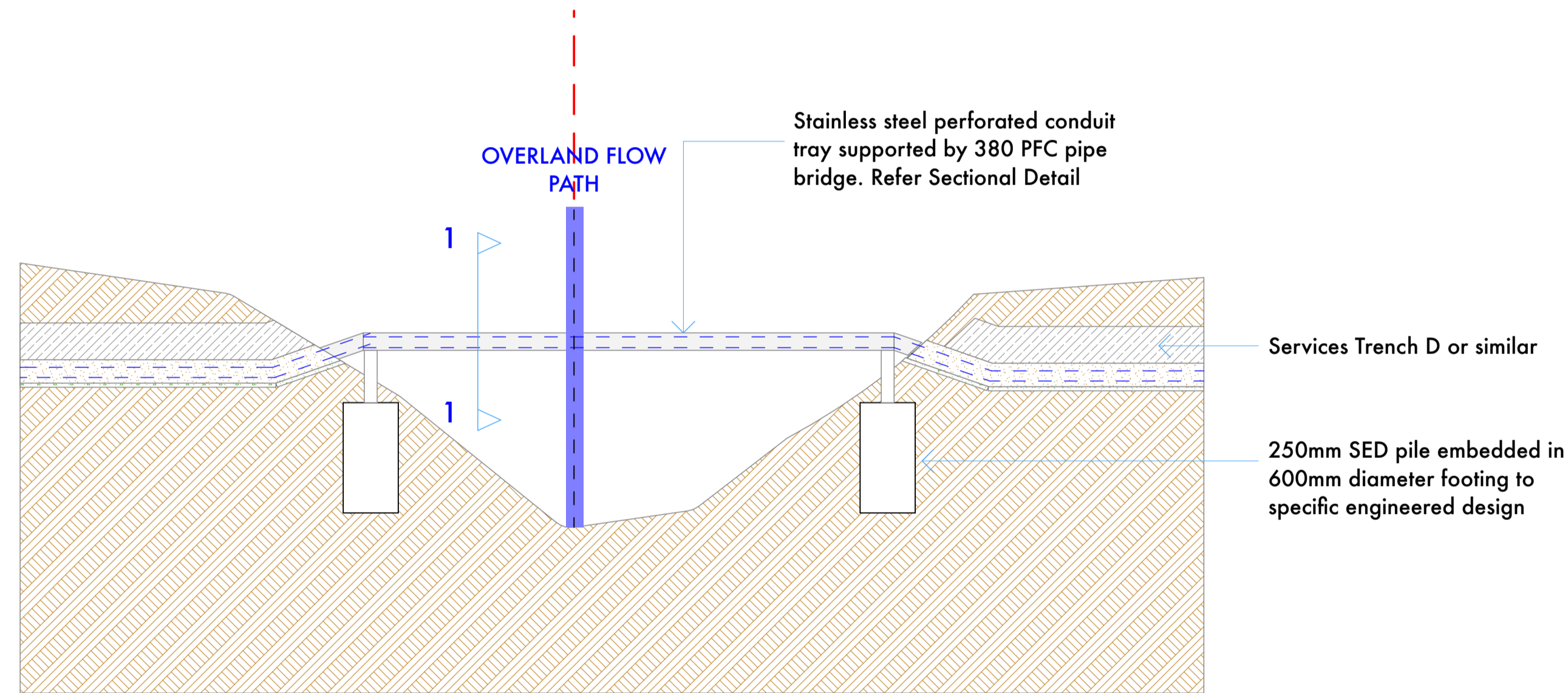

2
TYPICAL PIPE BRIDGE DETAIL
1:50

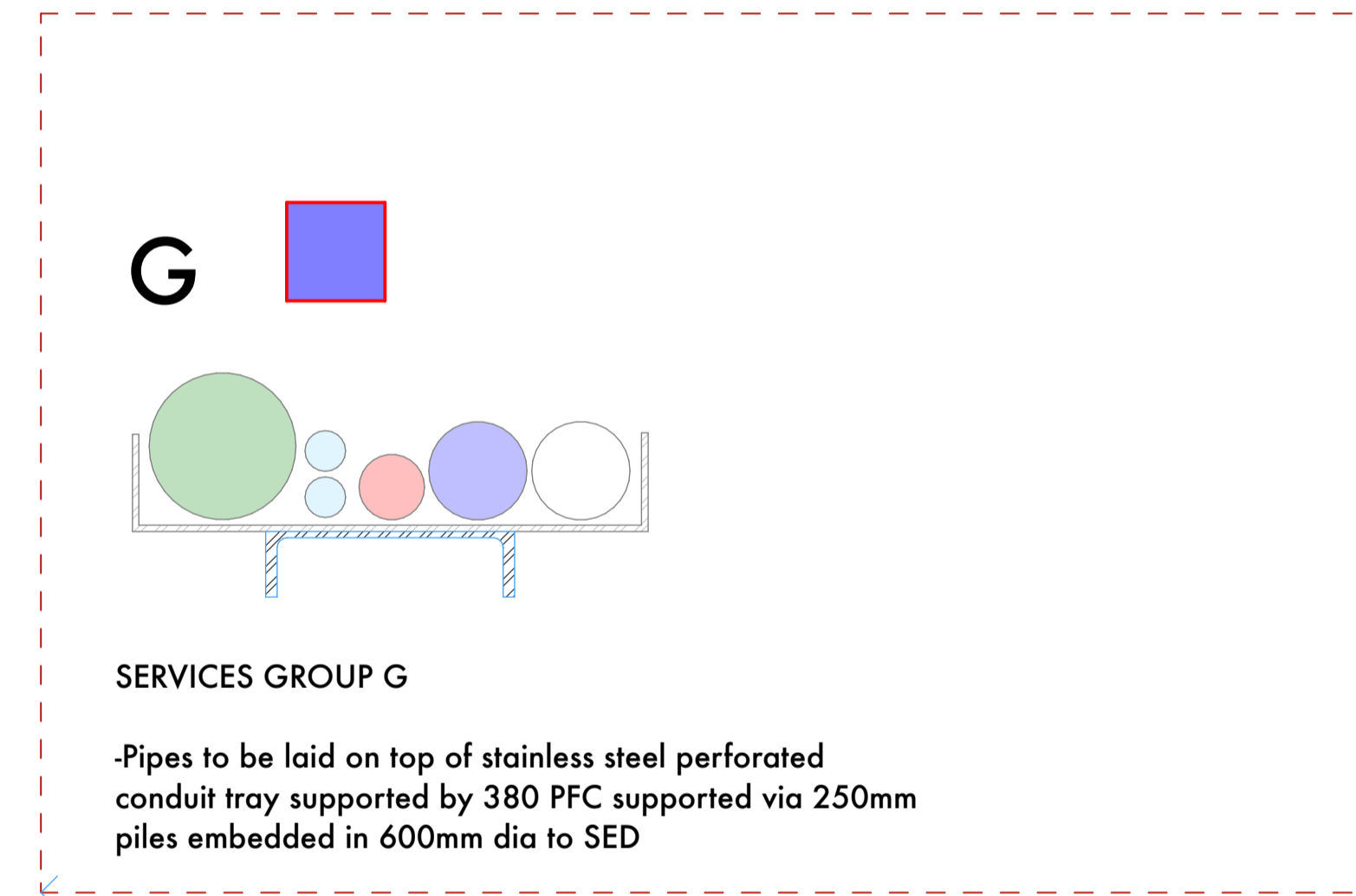

3
SECTIONAL DETAIL 1
1:10

SERVICES GROUP G

-Pipes to be laid on top of stainless steel perforated conduit tray supported by 380 PFC supported via 250mm piles embedded in 600mm dia to SED

09.09.21-REVISED ISSUE

SITE ADDRESS:	20 OMAHA BLOCK ACCESS ROAD LEIGH
LEGAL DESCRIPTION:	OMAHA 3 BLOCK- ML 148515
SITE AREA:	9.0421 HECTARES MORE OR LESS

DATE: 9/09/21

S-07

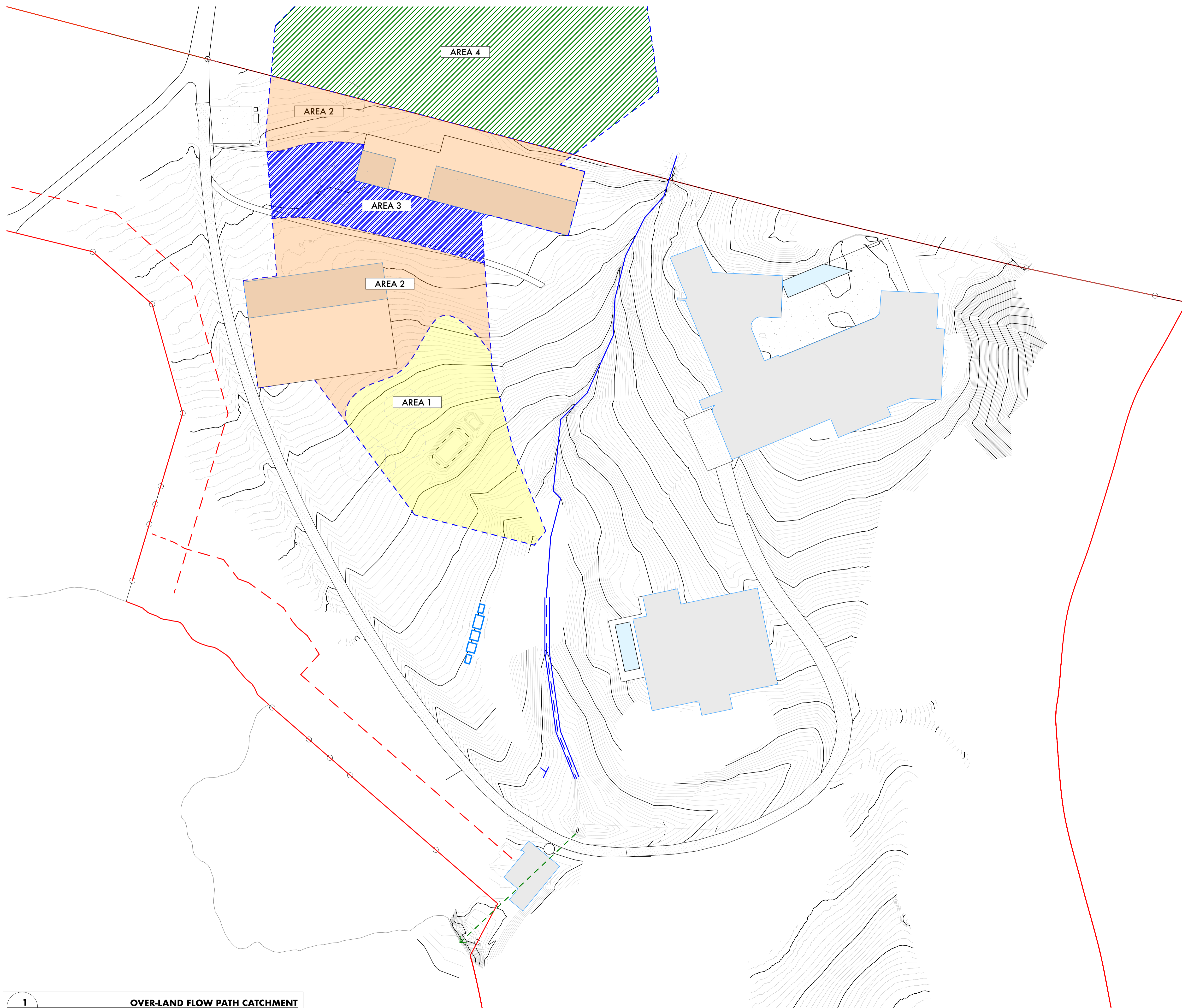

POST DEVELOPMENT AREAS:

AREA 1	[Yellow fill]	=2000 m ²
AREA 2	[Orange fill]	=3000 m ²
AREA 3	[Blue diagonal lines]	=1000 m ²
AREA 4	[Green diagonal lines]	=5415 m ²
Total		=11415 m ²

09.09.21-REVISED ISSUE

SITE ADDRESS:	20 OMAHA BLOCK ACCESS ROAD LEIGH
LEGAL DESCRIPTION:	OMAHA 3 BLOCK- ML 148515
SITE AREA:	9.0421 HECTARES MORE OR LESS
DATE: 9/09/21	

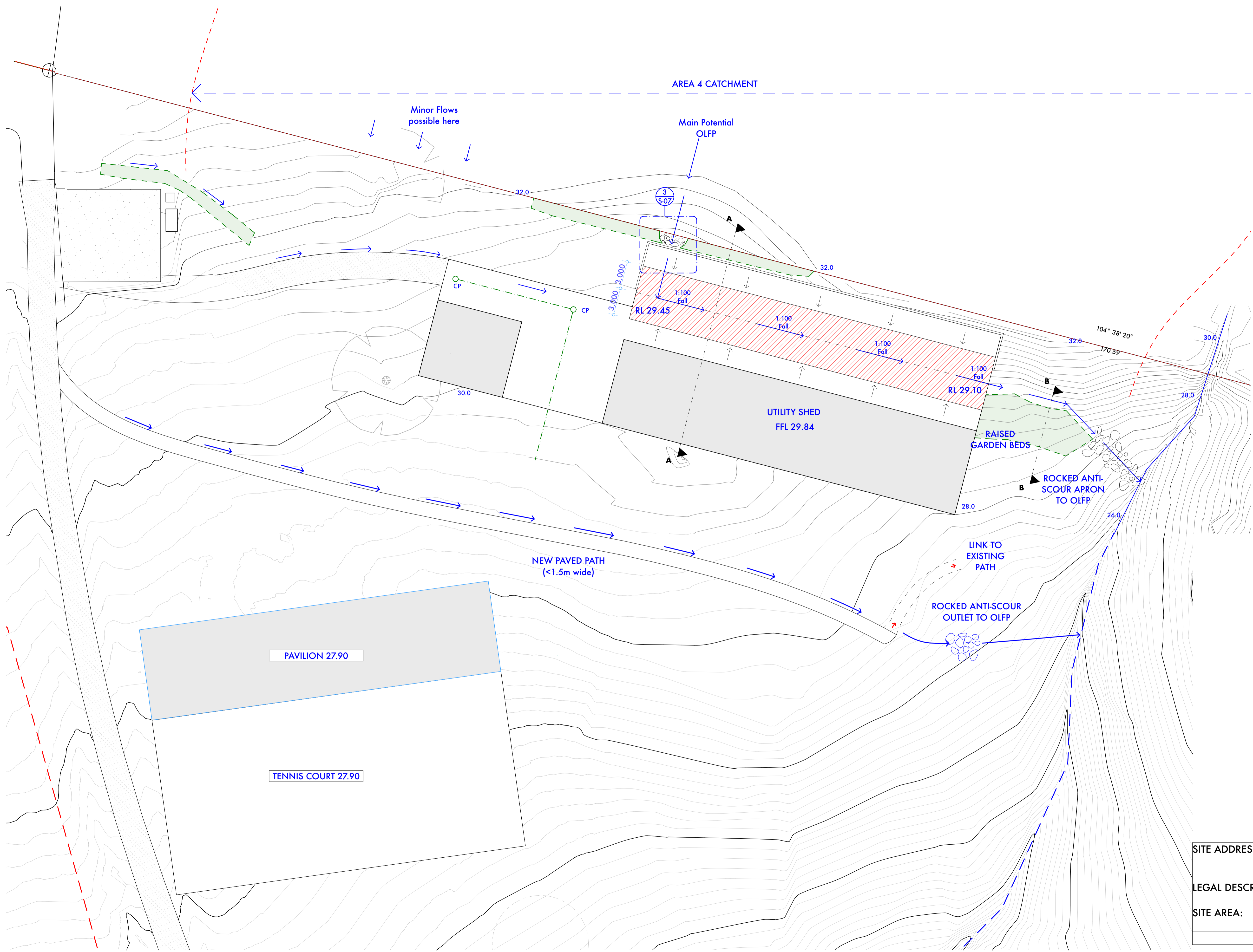

PAVILION 27.90

TENNIS COURT 27.90

09.09.21-REVISED ISSUE	
SITE ADDRESS:	20 OMAHA BLOCK ACCESS ROAD LEIGH
LEGAL DESCRIPTION:	OMAHA 3 BLOCK- ML 148515
SITE AREA:	9.0421 HECTARES MORE OR LESS
DATE: 9/09/21	

S-09